

USER'S MANUAL

SEMI-AUTOMATIC SHOTGUN

**READ THE INSTRUCTIONS AND WARNINGS IN THIS
MANUAL CAREFULLY BEFORE USING THIS FIREARM**

GUN SAFETY RULES

Observe these rules of safe gun handling.

- 1. Always keep the muzzle pointed in a safe direction. Watch the muzzle at all times: never point a gun, accidentally or intentionally, at any person or anything you do not intend to shoot. Identify the target before shooting; do not shoot at sounds.**
- 2. Always treat any gun as if it is loaded - it may be!**
- 3. Keep your finger off the trigger while operating the action and at all other times until you are ready to shoot**
- 4. Keep the safety “on” or in the “safe” position at all times until you are ready to fire the gun. Do not rely on your gun’s safety, the safety on any gun is a mechanical device and is not intended as a substitute for common sense or safe gun handling.**
- 5. Learn how your gun functions and handles. If you do not thoroughly understand the proper use and care of your gun, seek the advice of someone who is knowledgeable or a gunsmith.**
- 6. Do not alter or modify and parts of a firearm.**
- 7. Store guns unloaded, separate from any ammunition, and where children can not get to them.**
- 8. Be sure the barrel is clear of any obstructions before loading. Make it a habit to check the barrel every time before loading.**
- 9. Be sure you have and use the proper ammunition. A 20 gauge shell will enter a 12 gauge chamber far enough so that a 12 gauge shell can be loaded behind it. Also, a 3inch shell may fit into a 2 3/4 inch chamber, but the crimp at the mouth of the shell will unfold into the forcing cone. If either of these things occur and you fire the gun, the gun may explode, damaging the gun and possibly causing serious injury or death to you and those around you.**
- 10. Wear protective shooting glasses and adequate ear protection when shooting.**
- 11. Never climb or jump over anything, such as a tree, fence, or ditch, with a loaded gun. Open the barrel, remove the shells, and hand the gun to a friend or place it on the ground on the other side of the obstacle before crossing it yourself. DO NOT lean a gun against a tree or other object; it could fall and possibly discharge.**

12. Do not shoot at a hard surface or at water. The bullet and shot can ricochet or bounce off and travel in unpredictable directions with great velocity.

13. Never transport a loaded gun. Do not place a loaded gun into a vehicle. The gun should be unloaded and placed into a case when not in use.

14. Never drink alcoholic beverages before or during shooting.

ABOUT YOUR SEMI-AUTOMATIC SHOTGUN

Your Wimberley shotgun is gas operated. The gas created from firing a live shotshell operates the action. Once the first shell has been fired, the next shell in the magazine will automatically cycle into the chamber, and this cycle will continue (each time the trigger is pulled) until all shells loaded in the magazine have been fired. The bolt will remain locked in the open position after the last shell is fired.

The technologically advanced gas metering system allows you to shoot 1-1/8 oz, 2-3/4" and 3" shells interchangeably with any of the proper gauge for your shotgun with flawless performance. This and other fine features ensure that your shotgun will be a source of pride and pleasure for years to come.

SAFETY SWITCH OR BUTTON

The safety is designed to stop the trigger mechanism.

DON'T RELY ON YOUR GUN'S SAFETY. TREAT EVERY GUN AS IF IT WERE LOADED AND READY TO FIRE. The safety on any gun is a mechanical device, and it is not intended as a substitute for common sense or safe gun handling. Always keep the muzzle pointed in a safe direction.

A. The safety is located behind the trigger, and provides protection against accidental or unintentional discharge under normal usage when properly engaged.

1-) From the right the "on" or (photo 1.) Safety button protrudes.



B. To engage the safety, push the button in side of the gun. The safety should always be in 'safe" position until you intend to fire the gun.

C. When you are ready to fire the gun, press the to the 'off' or ' fire' position, so that the safety from the left side of the gun.

DANGER: The gun will fire when the trigger is pulled intentionally or accidentally when the safety button is out.

ASSEMBLY



In the packing, the shotgun is one part: receiver and barrel group assembled (photo 2).

To assemble the gun, from the beginning follow the steps below:

Unscrew the cap (photo 3) and remove the forend (photo 4).

Pull the bolt hanging latch placed on the rear side of the carrier (photo 5).

Assemble the barrel while centering the magazine and the receiver (photo 6).

Reassemble the forend (photo 7) and screw the cap onto the threaded magazine tube (photo 8)

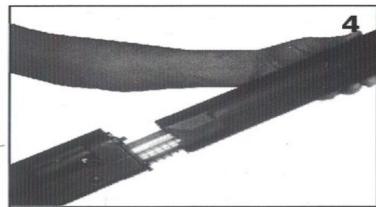
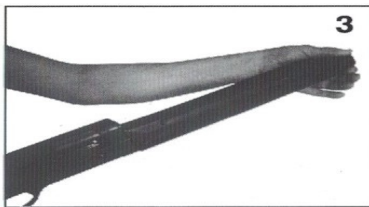

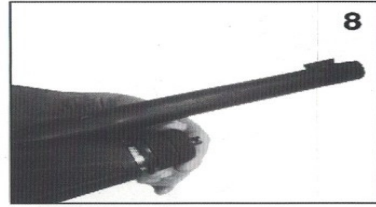
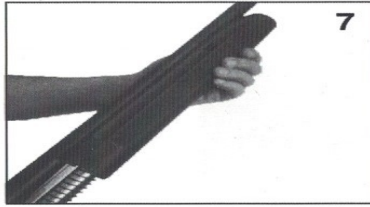
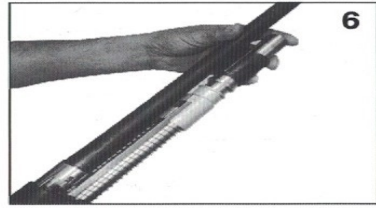
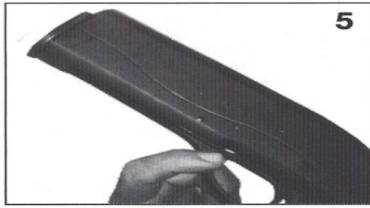

LOADING YOUR SHOTGUN

You can load your shotgun in the following ways:

1. Be certain the safety is in the “on” or “safe” position (see section regarding operation of the safety).

Draw or pull the bolt rearward until it locks in the open position (photo 12). Place a shell into the breach (photo 9). Release the bolt by pressing the button located toward the front of the receiver (photo 10). This chambers a round, and the gun will fire if the trigger is pulled with the safety in the ‘off’ or ‘fire’ position. You can then load additional shells into the magazine by inserting them through the loading port on the bottom of the receiver and pushing them into the magazine (photo 11)

2. Be certain the safety is in the “on” or “safe” position (see section regarding operation of the safety on page 3 and 4). Draw or pull the bolt rearward until it locks in the open position (photo 12). Load shells into the magazine by inserting them through the loading port on the bottom of the receiver and pushing them into the magazine [photo 11]. Push back the magazine shell latch on the rear side of the carrier (photo 13). This allows the shell to exit the magazine and move onto the carrier. Release the bolt by pressing the button located toward the front of the receiver (photo 10). This chambers a round, and the gun will fire if the trigger is pulled with the safety in the “off” or “fire” position.

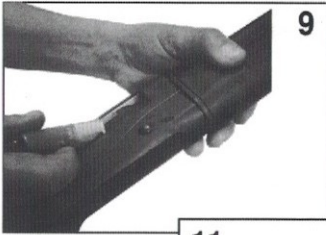

UNLOADING YOUR SHOTGUN

Be certain the safety is in the 'on' or 'safe' position (see the section regarding operation of the safety on pages 3 and 4). Rapidly draw or pull the bolt rearward to eject any shell in the chamber (photo 12). Lock the bolt open by pressing the button located toward the front of the receiver (photo 13). Lift the carrier and push on the magazine shell latch (photo 14). The shells in the magazine will be ejected.

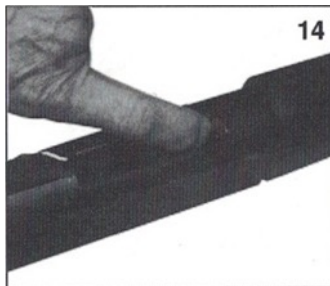
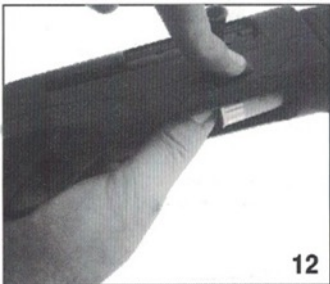

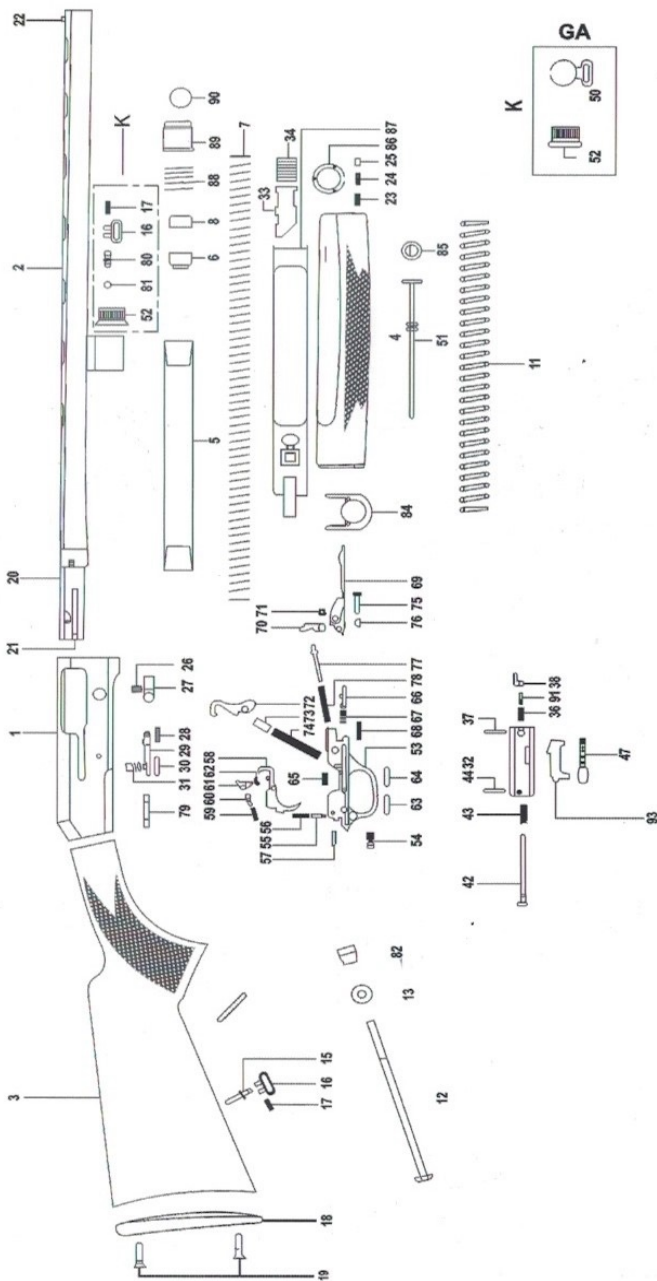

SPARE PARTS



PN	Description	PN	Description
1	RECEIVER	52	MAGAZINE CAP
2	BARREL	53	GUARD
3	STOCK	54	SAFETY
4	FORFARM	55	SAFETY PLUNGER
5	MAGAZINE TUBE	56	SAFETY SPRING
6	MAGAZINE FOLLOWER	57	SAFETY PLUNGER
7	MAGAZINE SPRING	58	TRIGGER
8	MAGAZINE SPRING RETAINER	59	SEAR SPRING
11	ACTION SPRING	60	SEAR PLUNGER
12	STOCK BOLT	61	SEAR
13	STOCK BOLT WASHER	62	SEAR PIN
15	STOCKSWIVEL STUD	63	TRIGGER PIN
16	STOCK SWIVEL	64	TRIGGER PIN
17	STOCK SWIVEL PIN	65	TRIGGER SPRING
18	BUTT PLATE	66	CARRIER PLUNGER
19	BUTT PLATE SCREW	67	CARRIER SPRING
20	BEARING BOLT	68	CARRIER RETAINING PIN
21	EJECTOR	69	CARRIER
22	FRONT BEAD	70	CARRIER LATCH
23	MAGAZINE CAP SPRING	71	CARRIER LATCH PIN
24	MAGAZINE CAP PIN	72	HAMMER
25	MAGAZINE CAP SCREW	73	HAMMER PLUNGER
26	BOLT RELEASE SPRING	74	HAMMER SPRING
27	BOLT RELEASE	75	TRIGGER ASSEMBLY PIN SUPPORT
28	BOLT RELEASE PIN	76	TRIGGER ASSEMBLY PIN RETAINER
29	BOLT RELEASE LATCH	77	CARRIER LATCH PLUNGER
30	BOLT RELEASE LATCH PIN	78	CARRIER LATCH SPRING
31	BOLT RELEASE LATCH SPRING	79	TRIGGER GUARD
32	BREECH BOLT	80	SWIVEL STUD
33	ARM PIPE	81	SWIVEL STUD RETAINER
34	CONNECTION RUBBER	82	STOCK BOLT RECEIVER
36	EXTRACTOR SPRING BOLT	84	PLATE
37	EXTRACTOR RETAINING PIN	85	MAGAZINE PLUG RETAINER
38	EXTRACTOR	86	MAGAZINE CAP SUPPORT
42	HIRING PIN	87	ACTION BAR
43	FIRING PIN SPRING	88	GAS PISTON SPRING
44	HIRING PIN RETAINER	89	GAS PISTON
47	OPERATING HANDLE	90	RUBBER GAS RING
50	FRONT SWIVEL	91	EXTRACTOR SPRING
51	MAGAZINE PLUG	93	LOCKING BLOCK

USAGE OF CHOKE TUBES

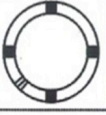
The choke is what controls the openness or tightness of the pattern of your shotgun. The chart below lists the choke available (from open to tight), and the correct sponding marks that indicate the choke of your specific shotgun.

	SKEET	M	F
CHOKE TUBE			
BBLS	CL	***	*

Never fire or run gun cleaning tools through a barrel that uses choke tubes without having a choke tube installed. The threads of the choke tube and the internal threads of the barrel should be cleaned after each use and before installation of the tube. To install a tube, insert the tube into the barrel and tighten with your fingers. Once the tube is finger tightened, tighten with the appropriate choke-tube wrench until the tube is snug. **DO NOT** over tighten or forcefully tighten with wrench.

MAINTENANCE AND CLEANING

Caution: Make sure the gun is unloaded.

We recommend lubricating with Slip 2000 EWL (Extreme Weapons Lubricant.) Apply a coat of EWL to all metal surfaces inside and out. Be sure to treat your bore as well. This will help prevent any carbon, plastic, copper, lead, and powder fouling from adhering and building up, and reducing your cleaning time.

Slip 2000 EWL is a synthetic CLP and metal treatment that bonds with metal creating a long lasting protective barrier. It will lubricate, clean and protect while not attracting dirt, dust, or sand. EWL will not freeze allowing your shotgun to run without issue in freezing temperatures and continue working smoothly for more rounds.

1. Make sure that the broad, polished, finely fitted mating surfaces of the breech block and receiver are especially clean and lightly oiled with EWL. Do not use pure silicone or lanolin.

2. Run an oil patch through the bore with a cleaning rod starting from the breech end . To prevent leading, use a cleaning solvent and brass brush to clean the bore periodically. Follow this cleaning with one or two clean oil patches.

Important: If your gun is equipped with choke tubes, do not use a steel brush to clean the barrels unless a choke tube is installed in each barrel. Barrels that utilize choke tubes must also have the choke tubes removed to clean and oil the threads inside the barrel and the choke tubes themselves. This will protect the threads from being damaged by cleaning tools and also prevent a dirt build up that would cause the choke tube to become difficult to remove from the barrel. Damage can result to choke tubes and barrel when attempting to remove sticky choke tubes. Never fire your gun without choke tubes snugly tightened in barrels. Do not over tighten choke tubes. Wipe all exposed metal surfaces with an oiled cloth before storing. Do not squirt or pour oil into the inside mechanism because it may hamper proper functioning and will soak the wood. After extended periods of heavy use, your gun should be taken to a qualified gunsmith to have the action disassembled for professional cleaning and lubrication.

3. Care for your wood stock and forearm the same way you would a piece of furniture with the same finish.

STORAGE

Clean thoroughly and oil your gun before storage. Store the gun in a case to prevent scratches and dents. Store in a dry place to prevent corrosion. Store the gun away from children and in place where it cannot be obtained by those unauthorized to use it. Always store gun unloaded and separately from any ammunition.

IMPORTANT USAGE OF STEEL SHOT

The choke (bore constriction) in all modern shotguns has been established based on the pattern performance of shot shells loaded with lead shot. When using the steel shot shells, you will notice a different performance in pattern density versus the established lead shot pattern, because the steel shot is harder and lighter than lead shot.

You should be aware of the following differences and cautions: Never shoot steel shot loads in a full choked barrel or full choke tubed barrel. Doing so may cause the barrel to swell or rupture. In general, steel shot fired with a modified choke will produce the equivalent of a lead full choke pattern. This will be true of all steel shot sizes up to and including no. 2. The established improved cylinder chokes will produce the equivalent of a (lead) modified choke pattern.

All steel shot sized larger than no. 2, and including special sized such as -F, etc., should be used only with improved cylinder chokes. These

steel shot sized, when used in impm,ed cylinder chokes, will produce patterns equivalent to (lead) full choke patterns. The established cylinder choke or bore will produce the equivalent of a modified (lead) pattern.

Additional information concerning the use of steel shot is available from Remington, Winchester, Federal and other ammunition companies.

SERVICE AGREEMENT AND LIMITED WARRANTY

Wimberley agrees to service its products free of charge for defects in materials and workmanship in accordance with the service agreement listed below. The obligation of Wimberley under this agreement is limited to the repair or replacement of unserviceable parts and does not cover any incidental or consequential damages. Other than the express warranty contained herein Wimberley makes no warranties, express or implied. Wimberley will repair or replace any unserviceable part(s) for one (1) year from date of purchase and further will supply free parts (Wood not included) for an additional two (2) years in accordance with the above warranty statement provided your firearm had not been altered, abused, willfully damaged, or damaged by overpressure ammunition. This agreement is not transferable; its benefits apply only to the original purchaser.

To obtain free service during the time this agreement is in effect, make sure your firearm is unloaded, and send it to Wimberley.

PARTS

To order parts, please email sales@wimberleyarms.com the following information: Your name, address, telephone number, firearm serial number, make and model. When we receive your request, we will send you an order form and a parts breakdown with prices.

SHIPPING

When returning your gun for service, please take care in packing. Disassemble your gun, wrap in paper or other protective media and place gun in the original box. [THIS BOX WILL PROTECT THE GUN BUT IS NOT DESIGNED FOR SHIPPING]. Warp box in a cardboard box approved for interstate shipping. Wimberley is not responsible for damage incurred during shipping.

Some Federal, State and local hunting regulation may require that a shotgun be limited to a maximum shell capacity of five [5] rounds. Your shotgun has been packed with a magazine plug for this purpose. maximum shell capacity of five [5] rounds. Your shotgun has been packed with a magazine plug for this purpose.

Installation

1. Remove the forend screw cap, the forend and the barrel.
2. At the threaded end of the magazine tube (where the forend screw cap fits) you will locate a black snap ring.
3. A large blade screw driver should be used to remove the snap ring. **CAUTION:** The snap ring will be under pressure from the magazine spring. Do not remove the snap ring in a manner where the ring could fly out and strike you or anyone else causing injury, particularly to the eye.
4. Compress the magazine spring into the magazine tube, and insert the magazine plug (small end first). Push the magazine plug and insert the snap ring so the snap ring end is flush with the end of the tube.

THANK YOU

Thank you for purchasing a Wimberley shotgun. We are sure this gun will bring you years of hunting and/or shooting pleasure. Your satisfaction is the key to our success. Please let us know if we can be of service and please relay any observations about our guns performance or appearance.

PURCHASERS RECORD

Model Number : _____

Purchase Date : _____

Gauge or Caliber : _____

Serial Number : _____

Purchase Price : _____

Store Name : _____

WARNING: Before shipping any firearm, be absolutely certain that it is unloaded. **DO not ship cartridges with a firearms.**

WARRANTY AND CONDITIONS

Any legitimate purchaser of a Wimberley gun is entitled, under the following conditions, to have it repaired free of charge (parts and labor) in the event of defects occurring that can be shown to be due to defective materials or Manufacturer.

This warranty is valid for one (1) year from the date of delivery of the product to its initial purchaser.

This warranty excludes any breakage of the wooden elements where such breakage is not due to an intrinsic defect of the wood.

This warranty will not apply where:

1. It is apparent that the alleged defect can reasonably be attributed to normal wear and tear of the gun, intentional damage, negligent maintenance, storage or use or to improper use (such as unsuitable or reloaded ammunition)

2. The gun has been converted or altered in any way.

Under the terms of this warranty, all repairs or replacements shall be affected within a reasonable time scale. All repairs, with or without replacement of parts, must be performed using to correct equipment by an Official Wimberley distributor or Wimberley approved service center.

The customer will be advised when the repaired or replacement gun is ready. It will either be held for collection or, if the customer so requests, can be delivered to his home address at his/her own risk and cost.

Any servicing or repair work carried out under the terms of this warranty shall not extend the warranty period or either the conditions thereof. However, the repair itself will be guaranteed for a period of one (1) year from the date the repaired gun becomes available. In the event that the gun is replaced with a new one, the full warranty shall begin, to apply from the moment the replacement gun is handed to the customer.

NOTES



www.wimberleyarms.com